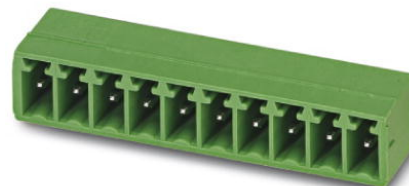

## MC 1,5/12-G-3,5

Order No.: 1844317

The figure shows a 10-position version of the product

<http://eshop.phoenixcontact.de/phoenix/treeViewClick.do?UID=1844317>Header, nominal current: 8 A, rated voltage: 160 V, pitch: 3.5 mm, no.  
of positions: 12, mounting: Soldering

### Commercial data

|                          |                    |
|--------------------------|--------------------|
| EAN                      | 4017918113353      |
| Pack                     | 50 Pcs.            |
| Customs tariff           | 85366990           |
| Weight/Piece             | 0.003131 KG        |
| Catalog page information | Page 152 (CC-2007) |

### Product notes

WEEE/RoHS-compliant since:  
01/01/2003

<http://www.download.phoenixcontact.com>  
Please note that the data given here has been taken from the online catalog. For comprehensive information and data, please refer to the user documentation. The General Terms and Conditions of Use apply to Internet downloads.

### Technical data

#### Dimensions / positions

|                     |              |
|---------------------|--------------|
| Height              | 7.7 mm       |
| Pitch               | 3.5 mm       |
| Dimension a         | 38.5 mm      |
| Number of positions | 12           |
| Pin dimensions      | 0,8 x 0,8 mm |

|                                    |        |
|------------------------------------|--------|
| Hole diameter                      | 1.2 mm |
| <b>Technical data</b>              |        |
| Insulating material group          | IIIa   |
| Rated surge voltage (III/3)        | 2.5 kV |
| Rated surge voltage (III/2)        | 2.5 kV |
| Rated surge voltage (II/2)         | 2.5 kV |
| Rated voltage (III/2)              | 160 V  |
| Rated voltage (II/2)               | 250 V  |
| Connection in acc. with standard   | EN-VDE |
| Nominal current $I_N$              | 8 A    |
| Nominal voltage $U_N$              | 160 V  |
| Maximum load current               | 8 A    |
| Insulating material                | PBT    |
| Inflammability class acc. to UL 94 | V0     |

#### Certificates / Approvals

#### Approval logo



#### CSA

|                       |       |
|-----------------------|-------|
| Nominal voltage $U_N$ | 300 V |
| Nominal current $I_N$ | 8 A   |

#### CUL

|                       |       |
|-----------------------|-------|
| Nominal voltage $U_N$ | 300 V |
| Nominal current $I_N$ | 8 A   |

#### UL

|                       |                                 |
|-----------------------|---------------------------------|
| Nominal voltage $U_N$ | 300 V                           |
| Nominal current $I_N$ | 8 A                             |
| Certification         | CB, CSA, CUL, GOST, UL, VDE-PZI |

## Accessories

| Item                | Designation             | Description  |
|---------------------|-------------------------|--|
| <b>General</b>      |                         |  |
| 1841161             | MC 1,5/10-LWL 1,5-3,5   | MINI-COMBICON optical fibers, pitch 3.5 mm, 10-position, divisible, are snapped into the back of the MC header, color: transparent, dimension a: 1.5 mm                  |
| 1841187             | MC 1,5/10-LWL 2,3-3,5   | MINI-COMBICON optical fibers, pitch 3.5 mm, 10-position, divisible, are snapped into the back of the MC header, color: transparent, dimension a: 2.3 mm                  |
| 1841200             | MC 1,5/10-LWL 4-3,5     | MINI-COMBICON optical fibers, pitch 3.5 mm, 10-position, divisible, are snapped into the back of the MC header, color: transparent, dimension a: 4.0 mm                  |
| <b>Marking</b>      |                         |  |
| 0804073             | SK 3,5/2,8:FORTL.ZAHLEN | Marker card, printed horizontally, self-adhesive, 10-section marker strip, 14 identical decades marked 1-10, 11-20 etc. up to 91-100, sufficient for 140 terminal blocks |
| <b>Plug/Adapter</b> |                         |  |
| 1734634             | CP-MSTB                 | Coding profile, is inserted into the slot on the plug or inverted header, red insulating material  |

## Additional products

| Item           | Designation        | Description   |
|----------------|--------------------|---|
| <b>General</b> |                    |   |
| 1840463        | MC 1,5/12-ST-3,5   | Plug component, nominal current: 8 A, rated voltage: 160 V, pitch: 3.5 mm, no. of positions: 12, type of connection: Screw connection |
| 1863259        | MCVR 1,5/12-ST-3,5 | Plug component, nominal current: 8 A, rated voltage: 160 V, pitch: 3.5 mm, no. of positions: 12, type of connection: Screw connection |
| 1862959        | MCVW 1,5/12-ST-3,5 | Plug component, nominal current: 8 A, rated voltage: 160 V, pitch: 3.5 mm, no. of positions: 12, type of connection: Screw connection |

## Drawings

### Drilling diagram

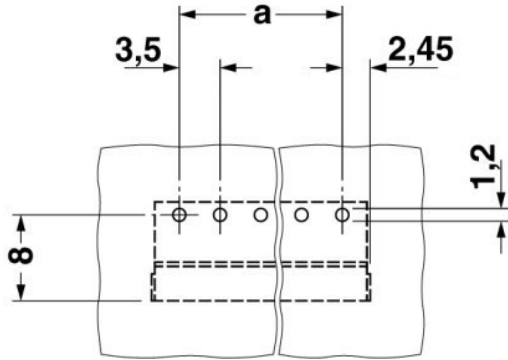

### Dimensioned drawing

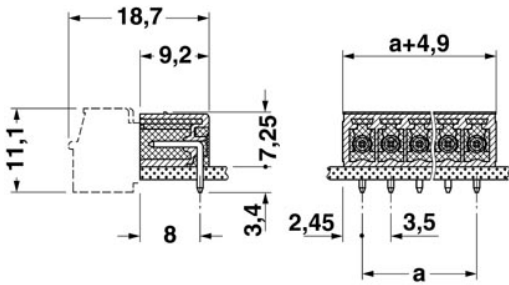

**Address**

PHOENIX CONTACT GmbH & Co. KG  
Flachsmarktstr. 8  
32825 Blomberg, Germany  
Phone +49 5235 3 00  
Fax +49 5235 3 41200  
<http://www.phoenixcontact.de>



© 2008 Phoenix Contact  
Technical modifications reserved;